

**CONTROLLER WIFI
ZFL1**

SAFETY RULES	3
CONNECTION DIAGRAM	3
QUICK START	4
MANUAL CONTROL	10
DECLARATION OF CONFORMITY	10
WARRANTY	11



PRODUCT DESCRIPTION

The ZFL1 radio controller is designed for remote operation of FAKRO WiFi accessories. There are two groups available in the ZFL1 device: the UP button - group no. 1 and the DOWN button - group no. 2. There are two control methods: short (0.5 sec.) and long (1-8 sec.) button presses. Buttons can trigger devices according to selected actions: UP, DOWN, STOP.

TECHNICAL SPECIFICATION

<p>Button type: Monostable (bell button)</p> <p>Groups: 2</p> <p>Dimensions: 82mm x 87mm x 46mm</p>	<p>Working temperature: -10°C to + 65°C</p> <p>Power voltage: 230VAC</p> <p>Energy consumption: <1W</p>	<p>Radio protocol: uWiFi, compatible with WiFi IEEE 802.11b/g/n (20 MHz)</p> <p>Radio frequency: 2.4 GHz</p>	<p>Radio working mode: - direct (access point) - via WiFi router (client)</p> <p>Encryption: WPA2-PSK and authenticated encryption (AEAD)</p>
--	---	--	---

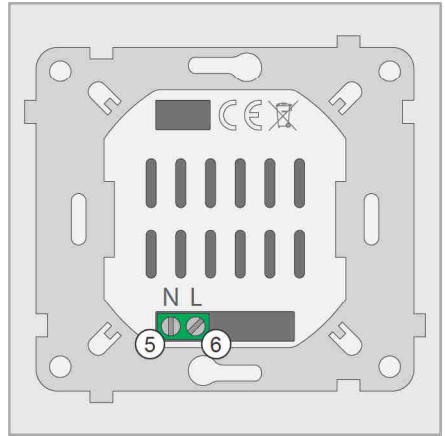
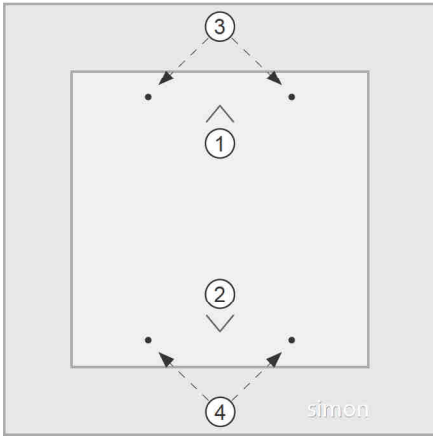

MODULE STRUCTURE

<p>① Control button - UP - channel no. 1</p> <p>② Control button - DOWN - channel no. 2</p> <p>③ Channel no. 1 signalling</p>	<p>④ Channel no. 2 signalling</p> <p>⑤ Neutral cable clamp</p> <p>⑥ Live cable clamp</p>
---	--

SAFETY RULES

- Read the instructions carefully before use.
- Install the device so that small children cannot access it.
- Radio range is directly dependent on the environment.
- When programming the ZFL1 controller to another WiFi device, please read the manual of that device carefully.
- The system supplying the set should be protected by means of a 10A fuse.

CONNECTION DIAGRAM

Connect the controller according to the diagram below.

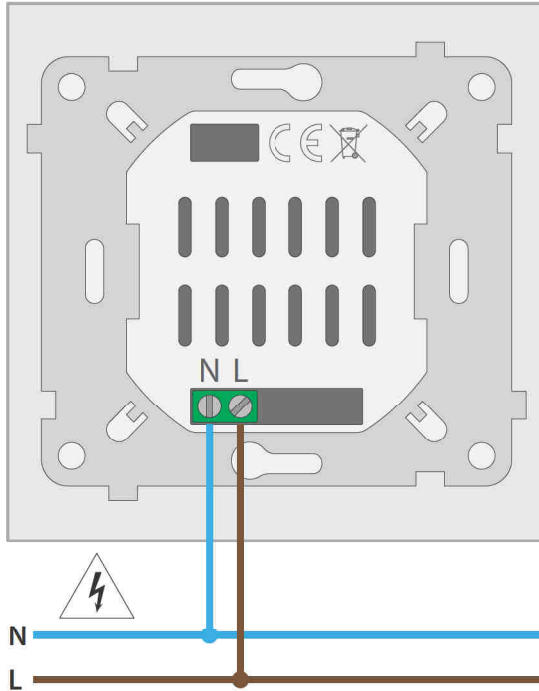

QUICK START

wBox APP DOWNLOAD

Download the wBox app using QR code or install it from Google Play or App Store.



ANDROID



IOS

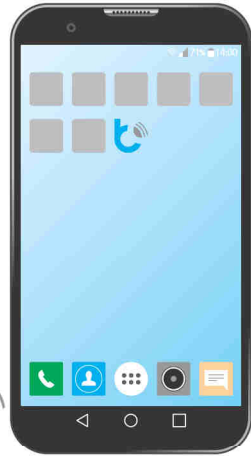

Follow the installer's instructions.

The app shortcut will be added to the home screen.



FOR INSTALLERS: Test the products on a non-logged wBox app.

When testing, do not select the option: + Add device to account.

This generates network data and assigns the product to the user carrying out the test.



Do not allow automatic connection to the device's WiFi.

ADD DEVICE TO HOME NETWORK

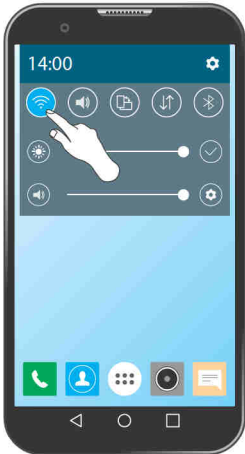

Turn on WiFi on your smartphone.



Connect to the device network you want to operate, eg. ARZ WiFi roller shutter.

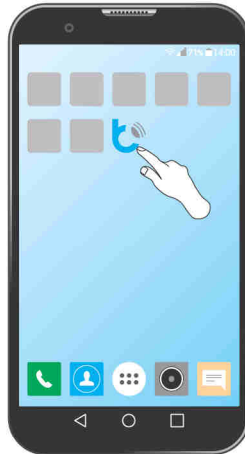

Run wBox app.

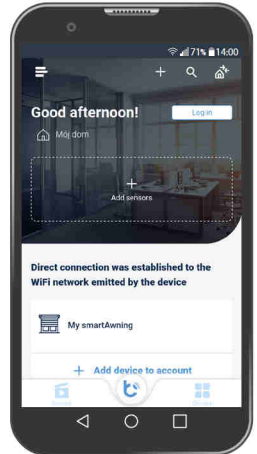

wBox app home screen.

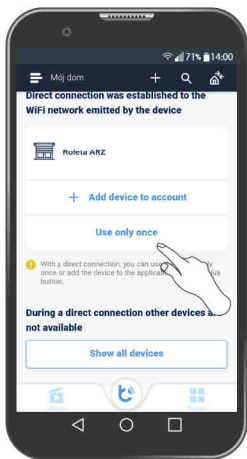

Scroll the home screen and select the "Use only once" function.

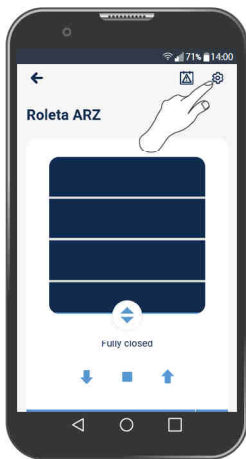

Go to device settings.

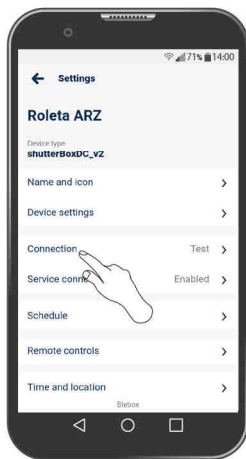

Go to the "Connection" section.

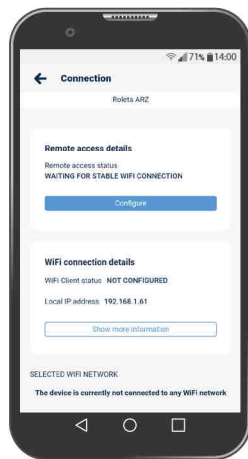

Scroll the screen to view available WiFi networks.

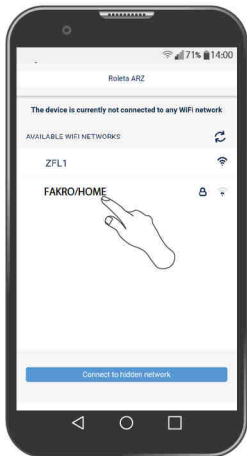

Select home network.

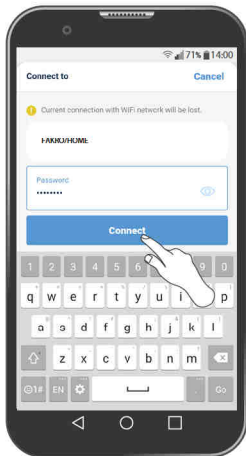

Enter the network password and connect to the network.

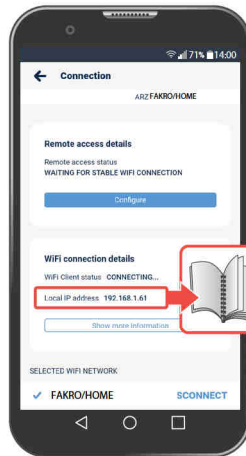

The device has been connected to the home network.

Note the IP address assigned by the FAKRO/HOME network for this device.

ADD ZFL1 CONTROLLER TO HOME NETWORK

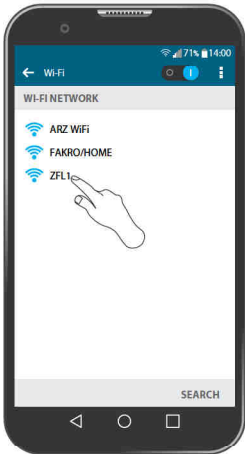

Connect to the ZFL1 controller network and run the wBox app.

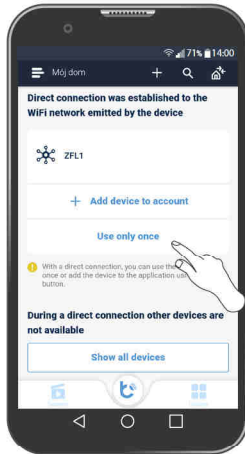

Scroll the home screen and select the "Use only once" function.

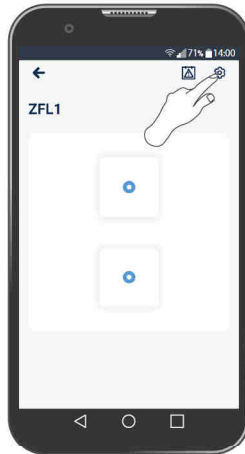

Go to settings.

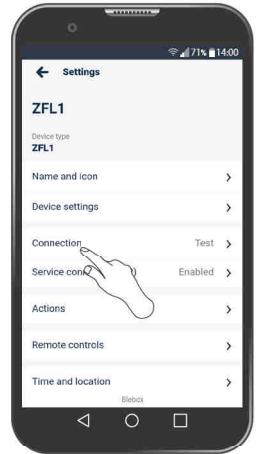

Go to the "Connection" section.

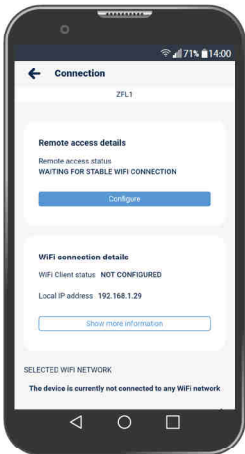

Scroll the screen to view available WiFi networks.

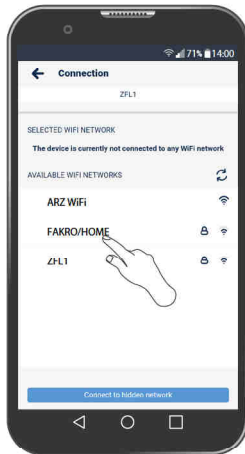

Select home network.

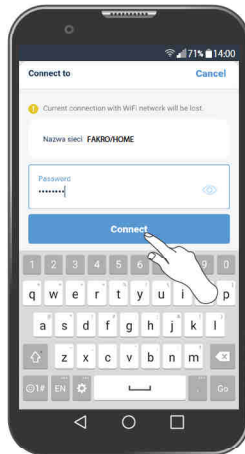

Enter the network password and connect to the network.

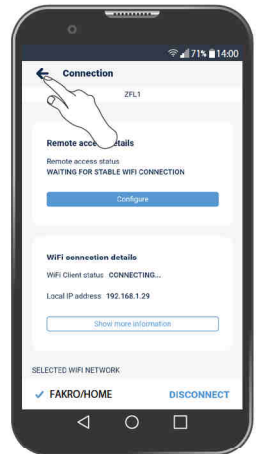

The controller has been connected to your home network. Go to the previous screen.

ADD ACTION TO CONTROL BUTTON

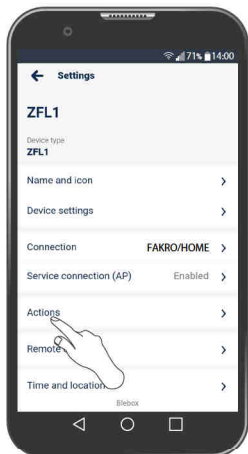

Go to the "Actions" section.

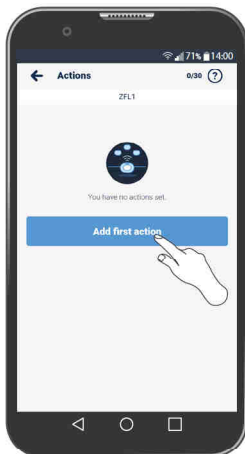

Add first action.

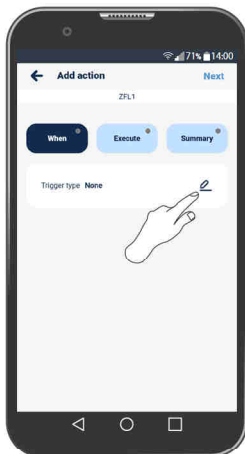

Select how to trigger the action.

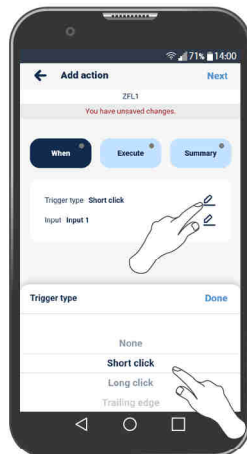

Select "Short click"

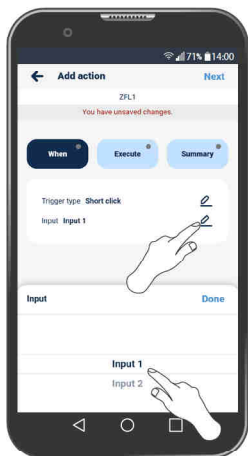

Select Input 1.

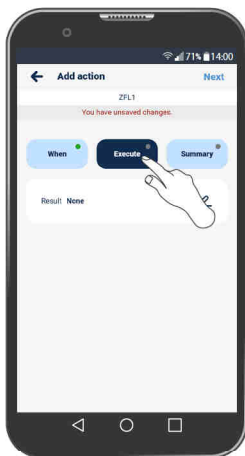

Go to the next section
(choice of reaction method).

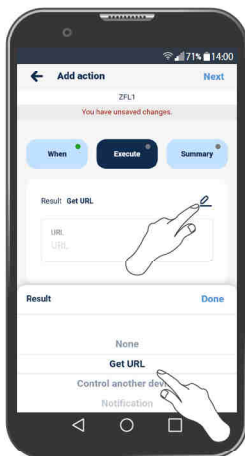

Select "Get URL".
This function will allow you to
connect to the controlled device
with a given IP address.



Entering the IP address of the controlled device, select the appropriate API command:

`http://xxx.xxx.xxx.xxx/s/u`
`http://xxx.xxx.xxx.xxx/s/d`
`http://xxx.xxx.xxx.xxx/s/s`

where:
`/s/u` – up
`/s/d` – down
`/s/s` – stop

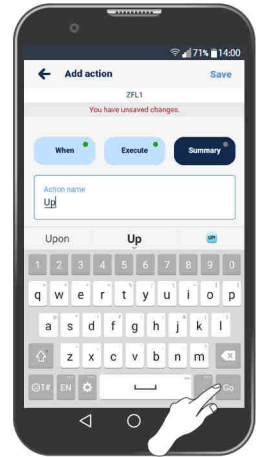
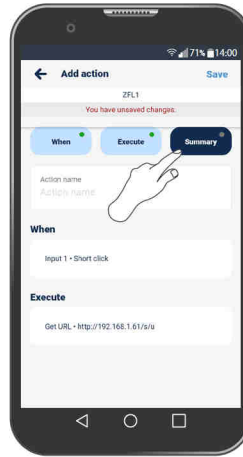
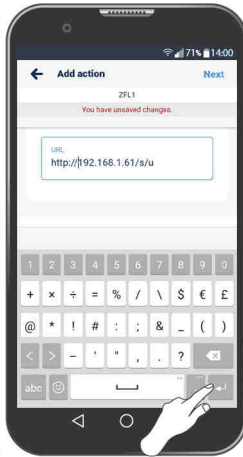

Enter the noted IP address with one of the selected actions.
 For the "UP" action it will be:
`http://xxx.xxx.xxx.xxx/s/u`
 Accept.



Go to summary.

Name the action and save it.

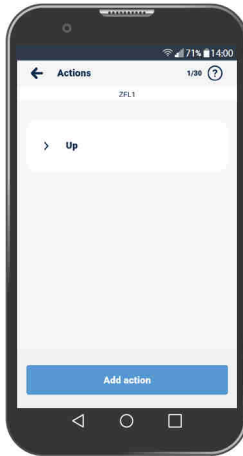
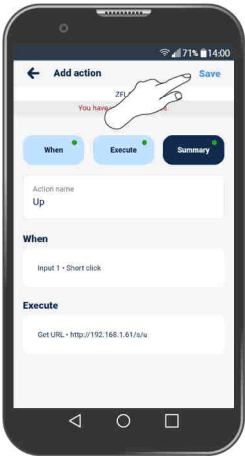

Save settings.

Selected function has been assigned to the device.

i To get full functionality you need to perform the procedure again for other actions: "Down", "Stop". A brief description of adding actions is presented on the next page.

ADD OTHER ACTIONS TO THE CONTROL BUTTON

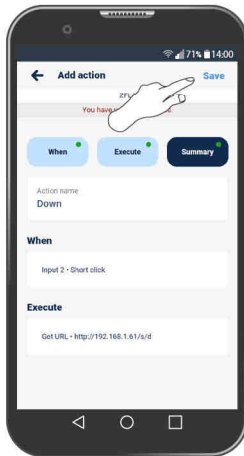
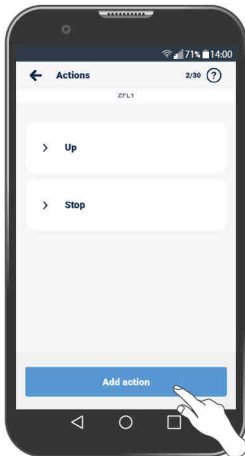
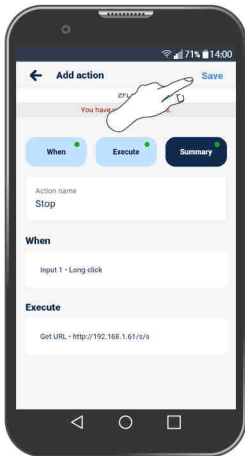
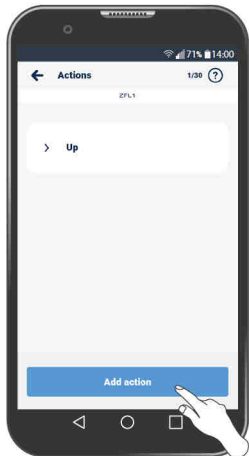

Add another action. Note the suffix in the IP address.

- Input 1 - "Long click"
- `http://xxx.xxx.x.xxx/s/s`
- "Stop".

Save.



Add another action. Note the suffix in the IP address.

- Input 2 - "Short click"
- `http://xxx.xxx.x.xxx/d`
- "Down".

Save.

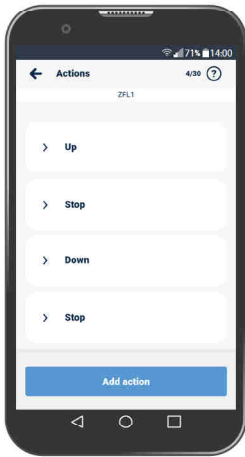
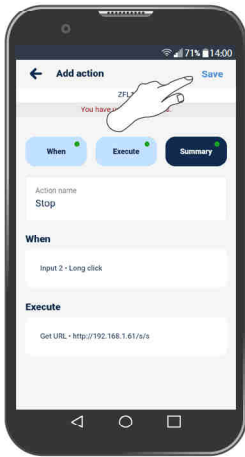
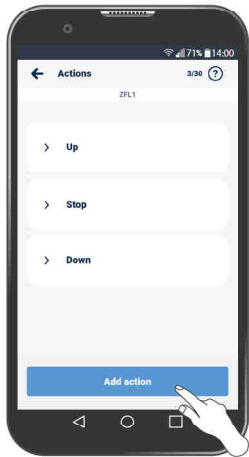

Add another action. Note the suffix in the IP address.

- Input 2 - "Long click"
- `http://xxx.xxx.x.xxx/s/s`
- "Stop".

Save.



All actions have been added.

MANUAL CONTROL

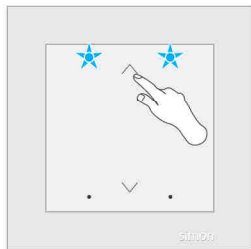

UP

SHORTLY PRESS the "UP" button to open.

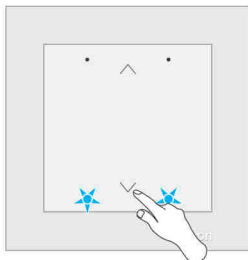

DOWN

SHORTLY PRESS the "DOWN" button to close.

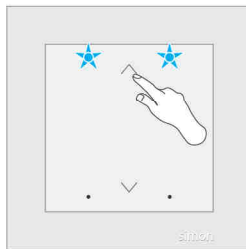

STOP

HOLD the "UP" button to stop.
HOLD the "DOWN" button to stop.

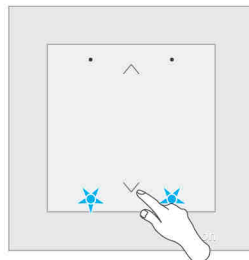

DECLARATION OF CONFORMITY

FAKRO Sp. z o.o. hereby declares that a type of radio device ZFL1 complies with the RED Directive 2014/53/EU.

The full text of the EU Declaration of Conformity can be found at:

<http://www.fakro.pl/architekci/certyfikaty-i-deklaracje/>

COMPLIANCE WITH THE WEEE DIRECTIVE

Devices marked with this symbol must not be disposed of or thrown away as household waste. It is the user's responsibility to deliver devices that are worn out to the designated recycling area.



WARRANTY



PL

<https://www.fakro.pl/serwis/gwarancja/>



GB

<https://www.fakro.com/service/customer-service/>

FAKRO Sp. z o.o.

ul. Węgierska 144A, 33-300 Nowy Sącz, PL
tel. +48 18 4440444, fax +48 18 4440333
www.fakro.com

Quality certificate:

Device

Model

Serial number

Seller

Address

Purchase date

Invoice No.

Signature (stamp) of person installing a device

